





SELF-CLEANING FILTER 100 MICRON

NEPTUNE 156 - NEPTUNE 159

 <p>ITEM 156</p>	 <p>ITEM 156.N</p>	<p>NEPTUNE 156 NEPTUNE 159</p> <ul style="list-style-type: none"> • Brass self-cleaning filter for water; • PN 25; • Cartridge 100 micron; • Inlet and outlet pressure gauge connections; • Maximum operating temperature: 130° C; • F.F. threaded connections; • 3/8" drain valve; • Available sizes: from 1/2" to 2". 	 <p>ITEM 159</p>	 <p>ITEM 159.N</p>
--	---	---	---	---

FIELDS:

Self-cleaning filters series NEPTUNE 156 and NEPTUNE 159 are suitable for installation in plants with the following characteristics:

Max inlet pressure:	25 bar
Max operative temperature:	130° C
Threaded connections:	ISO 228/1
Seepage rate:	100 micron
Suitable fluids:	Water

MATERIALS:

Metal of the body:	Brass alloy CB753S EN 1984
Metal of the nut:	Brass alloy CW614N UNI EN 12164
Cartridge:	Stainless steel AISI 304
Cartridge seats:	NBR 70 sh
O-rings:	NBR 70 sh
Plastic parts:	Ultramid® A3K (BASF)

ACCESSORIES:

Item 119.16	Radial pressure gauge 1/4" Ø 63 - 0-16 bar
Item 157	Cartridge 100 micron
Item 158	Cartridge 300 micron

Pressure always under control.

MAIN DIMENSIONS FOR SELF-CLEANING FILTER NEPTUNE 156

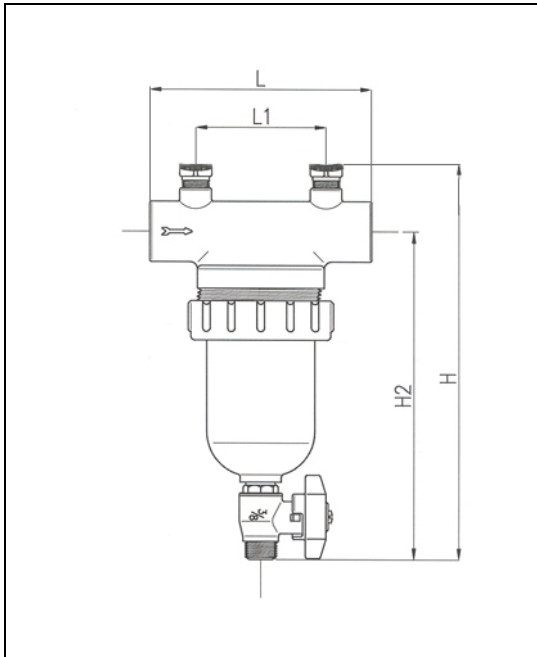

ITEM N.	DN	L	L1	H	H2
156.12	½"	118	70	196	165
156.34	¾"	118	70	196	165
156.33	1"	123	72	220	180
156.114	1" ¼	123	72	220	180
156.112	1" ½	153	98	258	214
156.58	2"	153	98	258	214

MAIN DIMENSIONS FOR SELF-CLEANING FILTER NEPTUNE 159

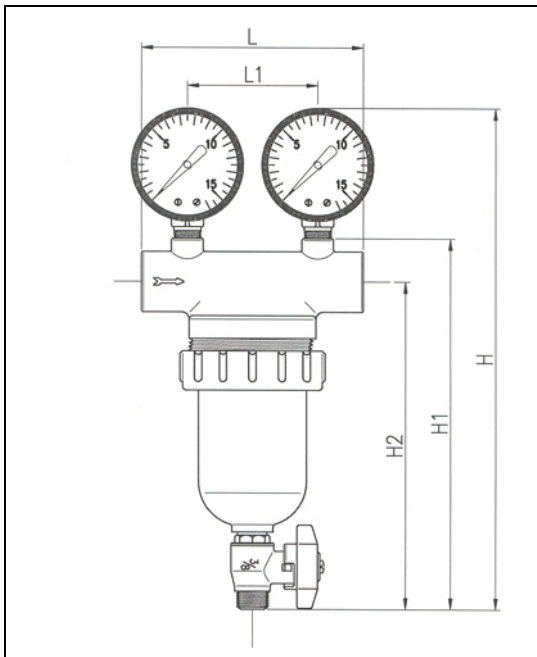

ITEM N.	DN	L	H	H1	H2	L1
159.12	½"	118	250	186	165	70
159.34	¾"	118	250	186	165	70
159.33	1"	123	280	212	180	72
159.114	1" ¼	123	280	212	180	72
159.112	1" ½	153	320	250	214	98
159.58	2"	153	320	250	214	98

Dimensions in mm.

FILTERING SURFACE

ARTICOLO	DN	mm ²
Neptune	½"	680
Neptune	¾"	680
Neptune	1"	1.180
Neptune	1" ¼	1.180
Neptune	1" ½	1.720
Neptune	2"	1.720

Pressure always under control.

DISCHARGE AND HEADLOSS CHART:

DIAGRAMMA DI PORTATA E PERDITA DI CARICO - DISCHARGE AND HEADLOSS DIAGRAM
FILTRI AUTOPULENTI - SELF CLEANING FILTERS

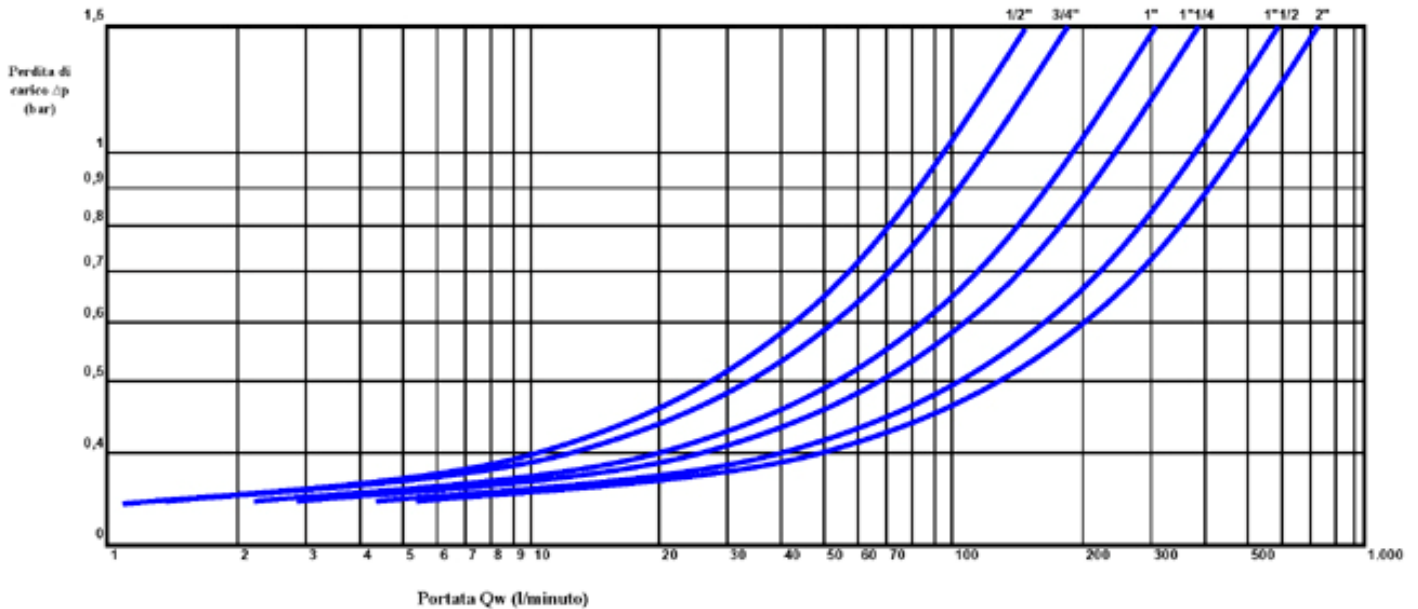

INSTALLATION AND FUNCTIONING OF SELF-CLEANING FILTERS

Although self-cleaning filters don't get the effect, in their functioning, of the gravity force, in order to better clean up the cartridge we suggest installing them horizontally:

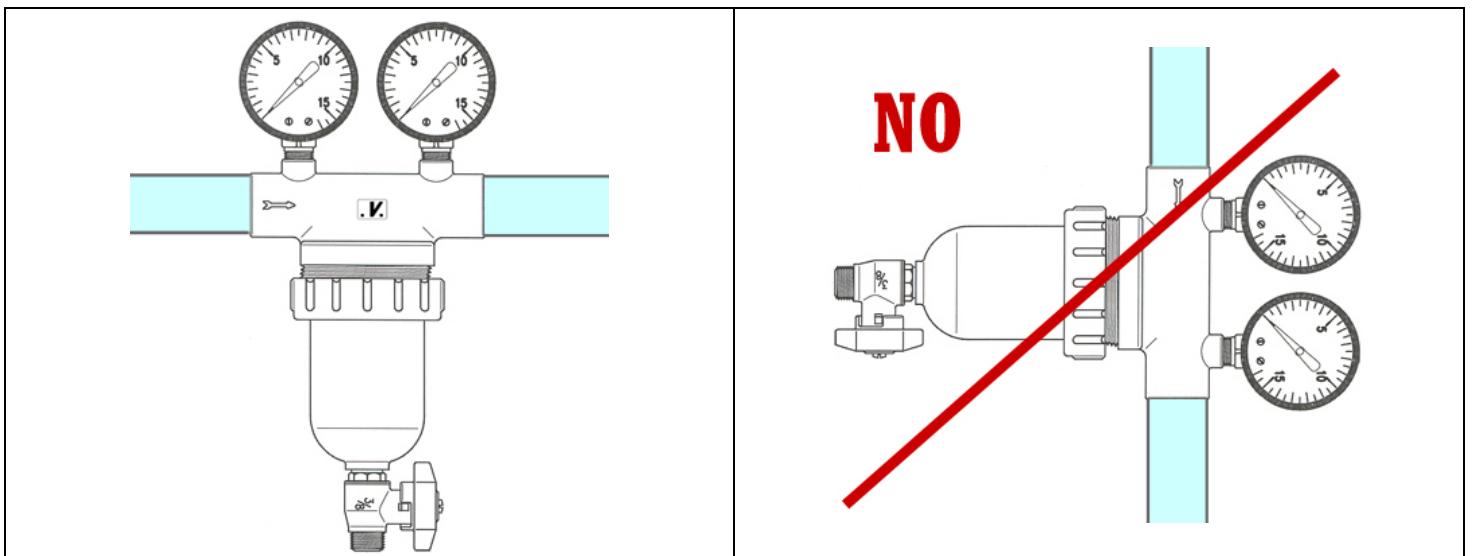

Fully built in brass, self-cleaning filters NEPTUNE can be installed just upstream the pressure reducing valve, avoiding in this way, all damages caused by sand to the devices placed downstream.

A typical installation of a self-cleaning filter when the cartridge is clean:

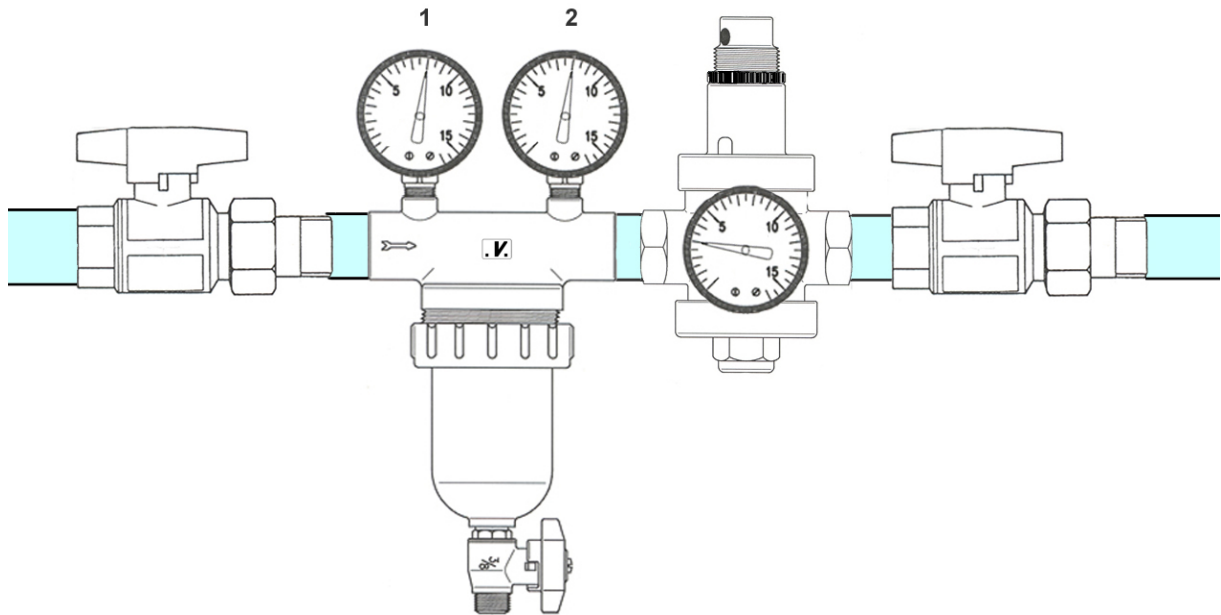

- pressure gauge N. 1: inlet pressure into the self-cleaning filter;
 - pressure gauge N. 2: outlet pressure from the self-cleaning filter;
- Both pressure gauges show the same pressure: the filter cartridge is clean.

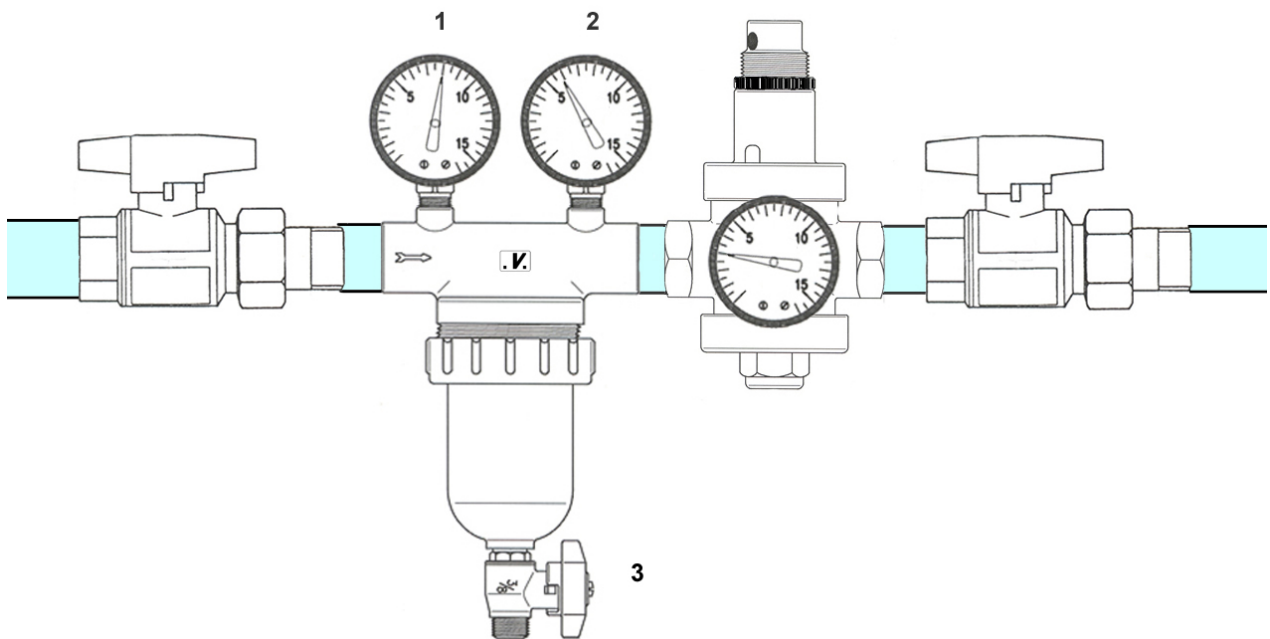

In this case pressure shown on gauge N. 1 is higher than pressure shown by gauge N. 2: the filter is dirty; by opening drain valve N. 3 the cartridge will be cleaned.

If, after this operation, the filter is still dirty, you will have to clean manually or, at least, substitute the inner cartridge. Mind to close system before starting this operation.